



Fonderie Sime S.p.A. - Via Garbo, 27 - 37045 Legnago (VR) - www.sime.it  
 Tribunale Verona 13531 - R.E.A. VR 171357 - C.C.P. 19423375 - N° Mecc. VR 014435  
 Capitale Sociale Euro 5.521.200 int. versato - Codice Fiscale/Partita IVA n. IT 01275930236

Comfort Ambiente - Via Garbo, 27 - 37045 Legnago (VR)

Tel +39 0442 631111 - Fax Servizio Commerciale: Italia +39 0442 631291 - Estero +39 0442 631293

Fax Servizio Tecnico +39 0442 631292 - Fax Ufficio Acquisti +39 0442 631292 - Fax Amministrazione +39 0442 631336

8112624 MINI 14 LN OF ERP

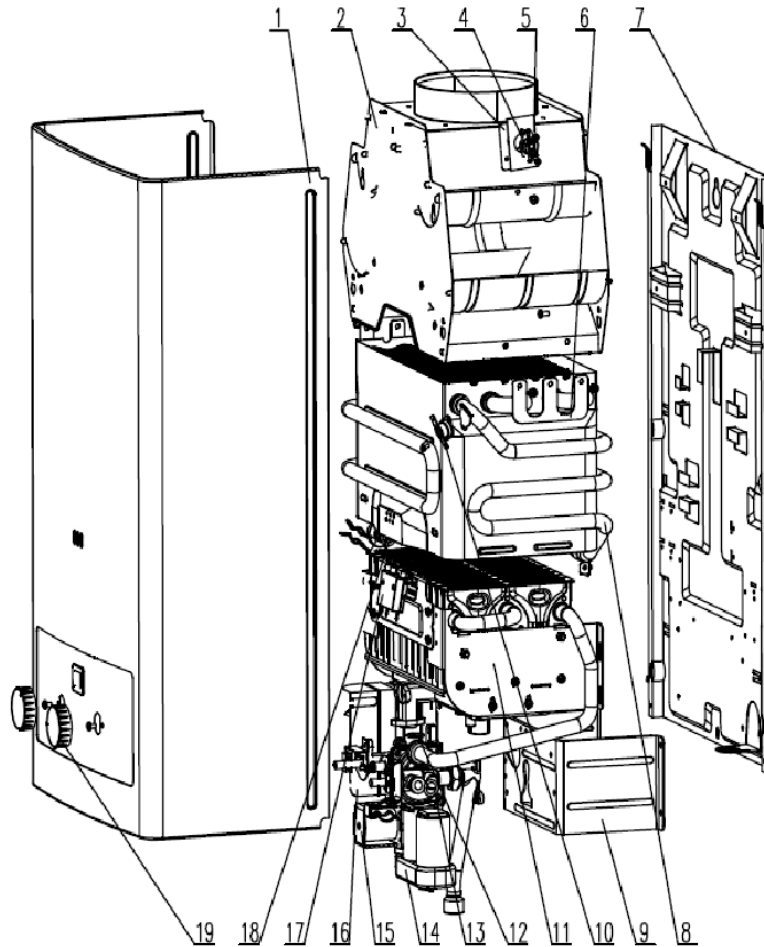

Position	Code	Description	Where used	Advised parts
001	6329551	Mantle assy		
002	6329571	Exhaust fume collect.hood assy		
003	6329572	Thermostat induction bracket		
004	6329573	Smoke stat		
005	6329562	Thermostat heat shield		
006	6329565	Mounting plate		
007	6329560	Bottom case		
008	6329574	Heat exchanger assy		
009	6329557	Bracket x water/gas link.valve		
010	6329567	Safety thermostat		
011	6329576	Burner assy met		
012	6329570	Gas tube sealing ring		
013	6329556	O-ring		
014	6329553	Battery box assy		
015	6329578	Water/gas link. valve assy-met		
016	6329552	Pulse igniter assy		
017	6329579	Ignition pin components		
018	6329568	O-ring		
019	6329550	Knob		